

Produced by the United States Geological Survey in cooperation with California Department of Water Resources
Control by USGS and NOS/NOAA
Compiled from aerial photographs taken 1974. Topography by plane-table surveys 1976. Map edited 1978
Selected hydrographic data compiled from NOS/NOAA Chart 18661 (1976). This information is not intended for navigational purposes
North American Datum of 1927 (NAD 27). Projection and 10 000-foot grid ticks: California Coordinate System, zones 2 and 3 (Lambert Conformal Conic)
1000-meter Universal Transverse Mercator grid ticks, zone 10 shown in blue
The difference between NAD 27 and North American Datum of 1983 (NAD 83) for 7.5 minute intersections is given in USGS Bulletin 1975. The NAD 83 is shown by dashed corner ticks
This map lies within a subsidence area
Vertical control based on last available adjustment

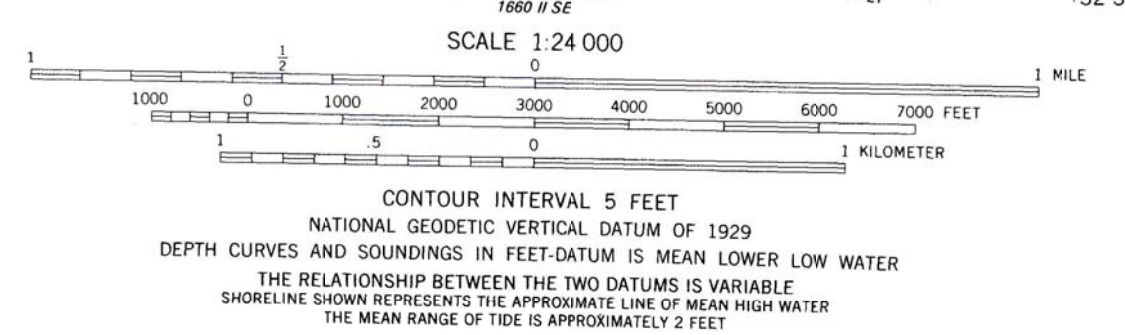
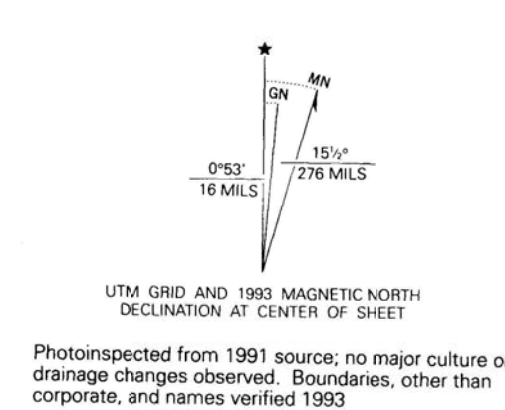

ROAD CLASSIFICATION

Primary highway, hard surface	Light-duty road, hard or improved surface
Secondary highway, hard surface	Unimproved road
Interstate Route	U. S. Route
	State Route

THIS MAP COMPLIES WITH NATIONAL MAP ACCURACY STANDARDS
FOR SALE BY U. S. GEOLOGICAL SURVEY, DENVER, COLORADO 80225, OR RESTON, VIRGINIA 22092
A FOLDER DESCRIBING TOPOGRAPHIC MAPS AND SYMBOLS IS AVAILABLE ON REQUEST

ISLETON, CALIF.
38121-B5-TF-024
1978
MINOR REVISION 1993
DMA 1660 II NE-SERIES V895